

## 2V100Ah @ 10HR

### Rekoser OPzV Battery

Rekoser OPzV battery. The RKV series adopts an Immobilized Gel and Tubular Positive Plate technology. It offers high reliability and stable performance. By using die-casted positive grid and patented active material formula, it exceeds the DIN standard values and offer 20+ years design life in float service. It is very suitable for cyclic use under extreme operating conditions. This series is recommended for telecom outdoor applications, renewable energy systems and other harsh environment applications.



#### Complied standards

- IEC 60896-11
- DIN40736
- IEC61427
- Eurobat guide, long life
- BS6290 part 4

#### SPECIFICATIONS

Nominal Voltage	2V			
Capacity (25°C)	100Ah @ 10HR			
Internal Resistance	Approx. 0.31mOhm (fully charged @ 20°C)			
Self Discharge	Approx. 2% per month @ 20°C			
Cell number	1 cells			
Capacity Affected by Temperature	102% (40°C)	100% (25°C)	85% (0°C)	65% (-15°C)
Charge Voltage (25°C)	Cycle - 2.35-2.40V (-5mV/°C/cell)		Float - 2.25-2.29V (-3mV/°C/cell)	
Max. Charge Current	20A			
Max. Discharge Current	800A			

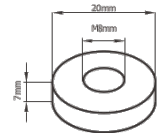
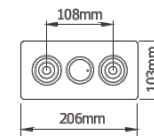

#### DIMENSIONS AND WEIGHT

Dimensions (mm)	103x206x354(390)
Weight (kgs)	13.0

#### CONSTRUCTION

Component	Raw Material
Positive	Lead dioxide
Negative	Lead
Container	ABS(UL94-V0 optional)
Cover	ABS (Flame Retardant Optional)
Sealant	Epoxy Resin
Safety Valve	Rubber
Terminal	Copper
Separator	Fibre Glass
Electrolyte	Immobilized Gel

#### GRAPHICS

CHARGE CHARACTERISTICS

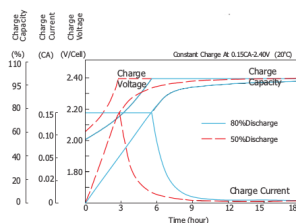

DISCHARGE CHARACTERISTIC 25°C

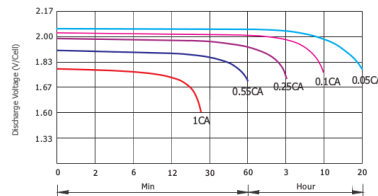

SELF DISCHARGE CHARACTERISTICS

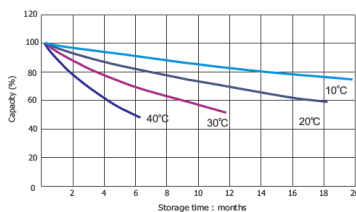

FLOAT VOLTAGE VS FLOAT LIFE

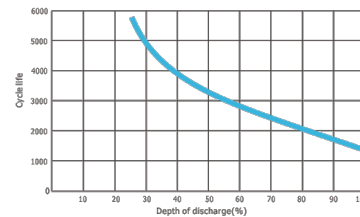

#### CONSTANT DISCHARGE RATINGS (A, W) AT 25°C

F.V / Time	15MIN		30MIN		1HR		3HR		5HR		10HR	
1.70 V	125A	208W	86.0A	148W	55.5A	117W	25.5A	50.2W	17.3A	37.8W	10.5A	21.5W
1.75 V	114A	184W	82.4A	144W	55.0A	106W	25.0A	50.1W	17.0A	36.9W	10.3A	20.1W
1.80 V	101A	163W	76.8A	138W	51.0A	96.9W	24.0A	49.5W	16.8A	36.0W	10.0A	19.9W
1.85 V	87.4A	150W	68.4A	124W	46.8A	91.9W	22.5A	47.9W	15.9A	34.8W	9.5A	19.1W
1.90 V	73.8A	138W	60.0A	110W	42.5A	86.9W	21.0A	46.3W	15.0A	33.5W	9.0A	18.2W