

12.8V18AH

Rekoser Lithium (LiFePO4) Battery

Rekoser Lithium (LiFePO4) battery. Lithium Iron Phosphate (LiFePO4) Battery offers up to 20 times longer cycle life and five times longer float/calendar life than lead acid battery. About 40% of the weight of a comparable lead acid battery. RKL is a 'drop in' replacement for lead acid batteries. BMS built-in.



Complied standards

- IEC 60896-21/22
- JIS C8704
- GB/T19639

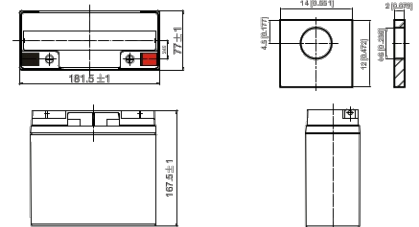

SPECIFICATIONS

| | |
|------------------------------|---|
| Nominal Voltage | 12.8V |
| Capacity (25°C) | 18AH |
| Energy | 230.4Wh |
| Internal Resistance | ≤50 m Ω |
| Cycle Life | >2000 cycles @1C 100%DOD |
| Self Discharge | 3% of capacity declined per month at 25°C |
| Efficiency of Charge | 100% @0.5C |
| Efficiency of Discharge | 96~99% @1C |
| Charge Voltage (25°C) | 14.6±0.2V |
| Charge Mode | 0.2C to 14.6V, then 14.6V,charge current to 0.02C (CC/CV) |
| Charger Current | 9A |
| Max. Charge Current | 18A |
| Charge Cut-off Voltage | 15.6V±0.2V |
| Continuous Discharge Current | 36A |
| Max. Discharge Current | 50A(<3s) |
| Discharge Cut-off Voltage | 8V |
| Charge Temperature | 0 °C to 45 °C (32F to 113F) @60±25% Relative Humidity |
| Discharge Temperature | -20 °C to 60 °C (-4F to 140F) @60±25% Relative Humidity |
| Storage Temperature | 0 °C to 40 °C (32F to 104F) @60±25% Relative Humidity |
| Water Dust Resistance | IP56 |

DIMENSIONS

| | |
|----------------|-----------------|
| Dimensions | 181x77x167(167) |
| Approx. Weight | 2.7 |

CONSTRUCTION

| | |
|---------------------|-------------------|
| Cell (Method) | 26650 (4S6P) |
| Case | ABS |
| Terminal Type | T3 |
| Protocol (optional) | SMBus/RS485/RS232 |
| SOC (optional) | LED |

GRAPHICS

RATE DISCHARGE CHARACTERISTICS 25°C

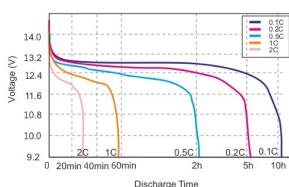

TEMPERATURE DISCHARGE CHARACTERISTICS 25°C

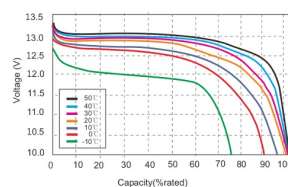

STATE OF CHARGE CURVE

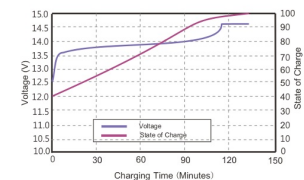

CHARGING CHARACTERISTICS

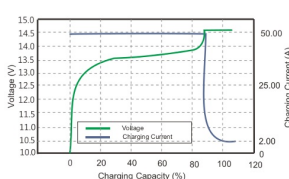

CYCLE LIFE CURVE

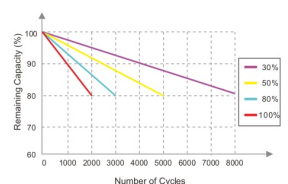

SELF-DISCHARGE CHARACTERISTICS

